

Driver \_\_\_\_\_ Date \_\_\_\_\_ Track \_\_\_\_\_ Event \_\_\_\_\_

### Track Condition

### Temperature

FRONT KICK-UP		
A-Mounts	B-Mounts	Kick-up
o	o	10°
oo	o	9°
ooo	o	8°
4	o	7°
5	o	6°
6	o	5°
o	oo	11°
oo	oo	10°
ooo	oo	9°
4	oo	8°
5	oo	7°
6	oo	6°
o	ooo	12°
oo	ooo	11°
ooo	ooo	10°
4	ooo	9°
5	ooo	8°
6	ooo	7°

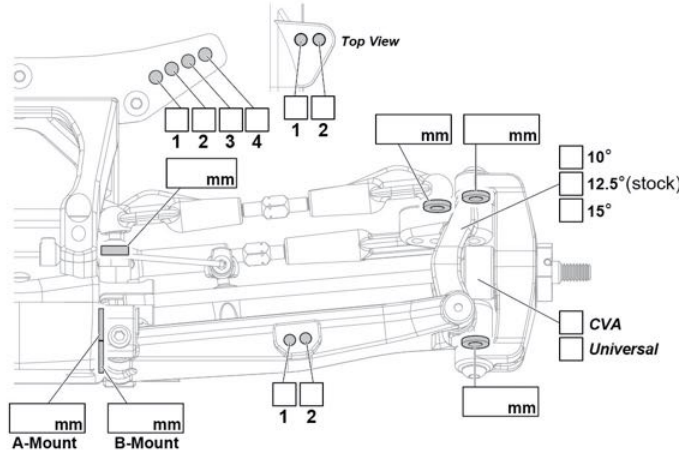

FRONT SHOCKS	
Oil wt.	_____
Piston	_____
Bladder	_____
Spring	_____
Notes	_____

Ride Height	_____ mm
Droop	_____ mm
Camber Angle	_____ °
Toe Angle	_____ °
Sway Bar	_____ mm
Shock Length	_____ mm

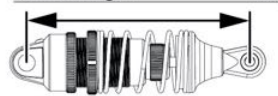

REAR ANTI-SQUAT		
C-Mounts	D-Mounts	Anti-Squat
o	o	0°
o	oo	1°
o	ooo	2°
o	4	3°
oo	o	-1°
oo	oo	0°
oo	ooo	1°
oo	4	2°
ooo	o	-2°
ooo	oo	-1°
ooo	ooo	0°
ooo	4	1°
4	o	-3°
4	oo	-2°
4	ooo	-1°
4	4	0°

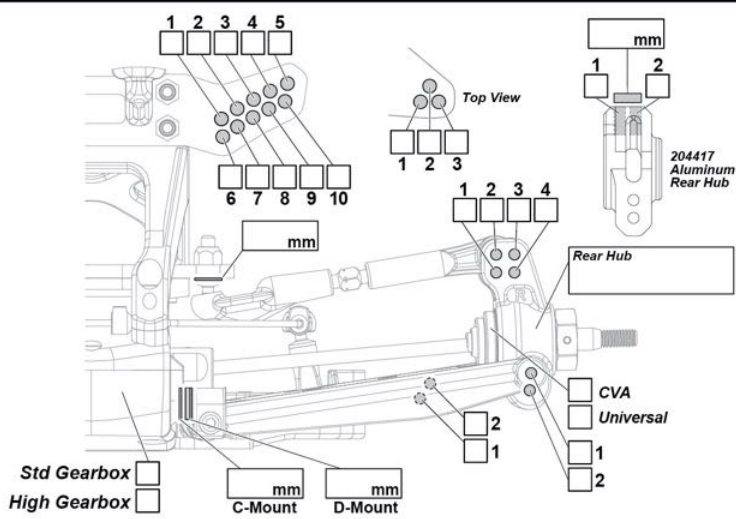

REAR SHOCKS	
Oil wt.	_____
Piston	_____
Bladder	_____
Spring	_____
Notes	_____

Ride Height	_____ mm
Droop	_____ mm
Camber Angle	_____ °
Toe Angle	_____ °
Sway Bar	_____ mm
Shock Length	_____ mm

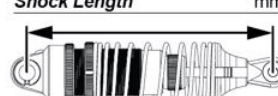

TIRES		
Front	Rear	
Tire	_____	_____
Insert	_____	_____

Battery \_\_\_\_\_  
 Motor \_\_\_\_\_  
 Gearing \_\_\_\_\_ / \_\_\_\_\_  
 Body / Wing \_\_\_\_\_ / \_\_\_\_\_

DIFF OIL			
	Front	Center	Rear
Brand	_____	_____	_____
Oil wt.	_____	_____	_____

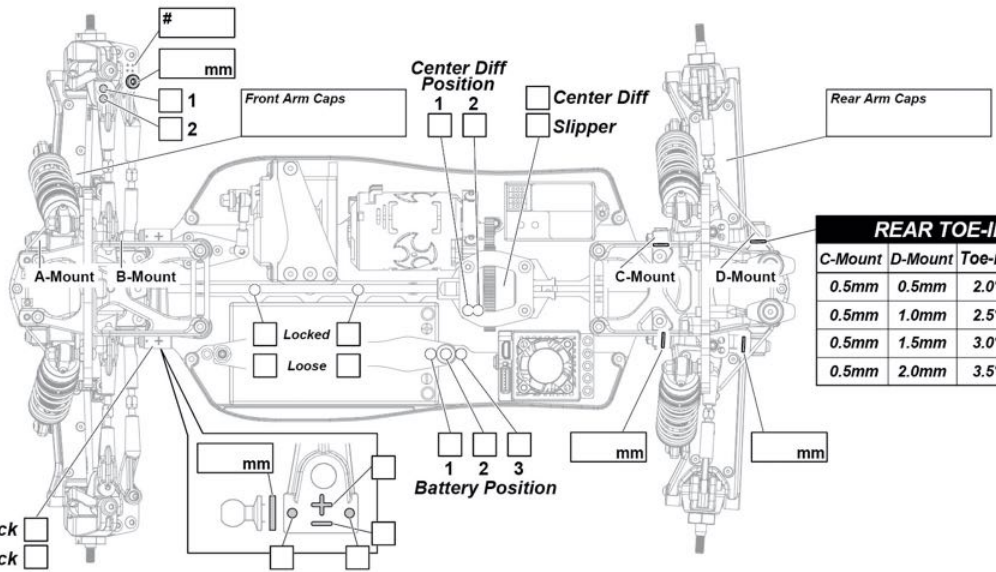

REAR TOE-IN		
C-Mount	D-Mount	Toe-in
0.5mm	0.5mm	2.0°
0.5mm	1.0mm	2.5°
0.5mm	1.5mm	3.0°
0.5mm	2.0mm	3.5°

Standard Steering Rack   
 204448 Alum. Steering Rack

Notes: \_\_\_\_\_  
 \_\_\_\_\_  
 \_\_\_\_\_

Gear Ratio =  $\frac{\text{Spur Gear}}{\text{Pinion Gear}} \times 3.3077$